

TO: Board of Directors
FROM: Katherine P. Craven, Executive Director
DATE: November 17, 2010
SUBJECT: Model School Status and Recommendations

I am pleased to provide this status update on the MSBA's model school program, which includes:

- Information on the Request for Services for additional model school submissions issued in October 2010;
- Staff recommendations for middle schools to be designated as model schools; and
- Staff recommendations for Districts to receive a Board invitation to participate in the model school program.

The model school program has been very successful for both local districts and the MSBA in building educationally sound schools in a fiscally responsible and timely manner. Under the model school program, districts have been getting shovels in the ground far more quickly than under the standard design process which requires an architect taking 12-18 months to design a school. Listed below, and included on Attachment B, are some examples of the success and savings generating from the model school program:

- Norwood – \$10M in bid savings. This is savings in addition to the \$26M in savings from their original project budget before they entered the model school pilot program. Change orders are under 0.6%. This school will open in 2011.
- Tewksbury – Over \$15M in bid savings. This school will open in 2012.
- Plymouth – Over \$10M in bid savings. This school will open in 2012.
- Natick – Over \$10M in bid savings. This school will open in 2012.
- Hampden-Wilbraham – Approximately \$13M in bid savings. This school will open in 2012.

Given the success of its model school program, the MSBA has continued to request designer submissions for adaptable school buildings that are flexible in educational programming spaces, are efficient in design, and incorporate sustainable design elements.

New Procurement:

- MSBA has posted a Request for Services (RFS) for qualified designers to provide professional design and construction administration services for the construction of a K-12 public, “model” school building consisting of *any* grade configuration. As the MSBA may still consider proposals submitted in response to a previous RFS, projects submitted previously do not need to be resubmitted.
- This RFS provides an additional submittal opportunity for all K-12 schools to be considered as potential candidates. This provides an opportunity for designers who may have missed a previous request or who may have thought their design did not meet the model school criteria. The MSBA has incorporated lessons learned from each of the model school requests and has broadened some of the eligibility criteria.
- With the recommendation and assistance of Board members, MSBA staff has revised the previous approach to allow for a more streamlined, multi-step submission process. Designers have been requested to propose a school(s) providing a minimum amount of information from which the MSBA may determine if additional consideration is appropriate. Only after the MSBA’s favorable review of the initial information and a site visit, if warranted, will the MSBA request a Designer to submit additional detailed information. This revision is aimed at addressing concerns received from the architectural community who requested a more streamlined application to submit their designs for MSBA further consideration.
- Responses are due on December 2, 2010.

Recommendations for model middle schools:

The MSBA’s model school program currently includes three high schools and four elementary schools as shown on Attachment A. Seven districts have selected model high schools, and on November 1st, the recently approved elementary schools were presented by the designers in the first selection process for an elementary model school. Districts who have received invitations have welcomed the opportunity to consider the model schools and to be considered eligible for participation in the model school program. At today’s Board meeting, staff is recommending that two middle schools, shown below, be considered for the model school program. The addition of these schools will allow the MSBA to expand the grade configurations offered in the model school program.

School	Designer	Design Enrollment	Grade Structure
Ipswich Middle/High School	Flansburgh Architects	1,205	6 to 12
Lynnfield Middle School	Ai3 Architects	687	5 to 8

Recommendations for District invitations

On November 1, 2010, the MSBA invited four Districts with proposed elementary school projects in the capital pipeline to a presentation from each of the four model elementary school designers. Each Designer of a model elementary school was provided with the basic information regarding the four invited districts as summarized in the table below. The Districts were required to bring a minimum of three representatives and after attending this informational presentation, each District was requested to submit a letter to the MSBA to include:

- The District’s request either to be considered for the model school program or not to be considered; and
- The District’s evaluation of which model school was best suited for adaptation to meet is educational program and needs.

District	School	Grades	Agreed upon Enroll	MSBA approved Preferred Schematic	Current Designer
Douglas	Douglas Intermediate School	2 to 5	552	Pending approval of 83,100 square feet of new construction	DiNisco Design Partnership, Ltd.
Fairhaven	Rogers Elementary School	K to 5	370	None submitted	HMFH Architects, Inc.
Marblehead	Glover and Eveleth School	K to 3	425	Approved New construction 79,731 square feet	JCJ Architecture
Westfield	Abner Gibbs Elementary School	K to 5	600	None submitted	None

Based on the presentations and after discussions with these Districts, two Districts have requested to be invited into the model school program: Douglas and Westfield. These Districts are being presented today for a vote by the Board of Directors for an invitation to the model elementary school program.

In addition to these Districts, the MSBA is recommending four additional districts as noted below for an invitation into the model school program. Based on staff’s preliminary analysis and review, it appears that the four schools listed below may be good candidates for the model school program and staff is recommending that the MSBA should work with these Districts to conduct a selection process similar to that performed for the elementary schools to determine if there is a model school that suits their design enrollment, educational program and site. All of the following schools have previously received invitations to feasibility study from the MSBA Board of Directors with the exception of Hingham. Staff’s recommendation is to invite Hingham in to feasibility study with consideration and participation in the model school program.

District	School	Model School Invitation	Design Enrollment	Model School	Designer
Quincy	Quincy Middle School	Middle School	600	TBD	TBD
Hingham	Middle School	Middle School	~1000	TBD	TBD
Duxbury	MS/HS	MS/HS	~1700	TBD	TBD
Harwich-Chatham	High School	High School	~750	TBD	TBD

Attachment A

High School and Elementary Schools in the Model School Program

High Schools

School	Designer	Enrollment
Ashland High School	Mount Vernon Group	900 academic, 1,100 core
Hudson High School	SMMA	1200
Whitman-Hanson Regional High School	Ai3	1,350

Elementary Schools

School	Designer	Enrollment
East Fairhaven, Fairhaven, Ma	HMFH	475
Fort Banks Elementary School, Winthrop, MA	DiNisco Design Partnership	650
Northeast Academy, Groton, CT	JCJ Architecture	450
Williamstown ES, Williamstown, MA	Margo Jones/Turowski Architecture	600

Attachment B

Status of model school Districts:

District	Board Invitation	Architect	Phase	NTP	Occupancy	Bid Savings
Norwood	8/1/2008	Ai3	Construction	5/19/2009	6/1/2011	\$10 M
Hampden-Wilbraham	8/1/2008	Mount Vernon Group	Construction	8/1/2010	6/28/2012	\$12.9 M
Tewksbury	1/1/2009	SMMA	Construction	10/14/2010	6/1/2012	\$15.1 M
Plymouth	3/1/2009	Ai3	Construction	4/28/2010	5/11/2012	\$10.4 M
Natick		Ai3	Construction	9/22/2010	6/1/2012	\$10.5 M
West Springfield	11/1/2008	TBD	Designer Selection			
East Bridgewater	5/1/2010	Ai3	Schematic Design			
Somerset-Berkeley	1/1/2009	TBD	OPM/Designer Selection			

Ipswich Middle / High School

Project Data

District: Ipswich Public Schools
Designer: Flansburgh Architects
Grades Served: 6 - 12
Design Enrollment: 1,205
Gross Floor Area: 209,400

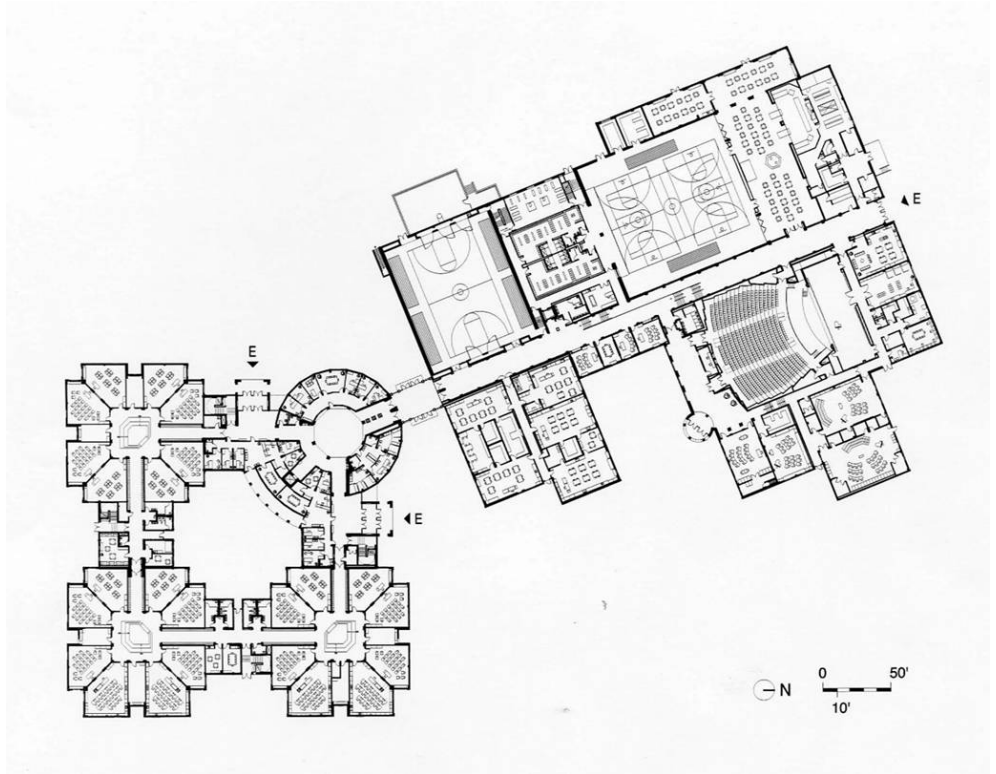

Lynnfield Middle School

Project Data

District: Lynnfield Public Schools

Designer: Ai3 Architects

Grades Served: 5 - 8

Design Enrollment: 687

Gross Floor Area: 110,170

