

This Diagram is being provided solely as an informational tool and it is not intended to represent an acceptable design for any specific facility. The legal requirements that govern the Design and Construction of a school facility are provided under Massachusetts General Law and these include any applicable requirements set forth in MGL c. 74. The MSBA is not responsible for the Owner's compliance with those legal requirements and compliance is the exclusive responsibility of the Owner and its professional consultants. This Diagram is for purposes of discussion of Chapter 74 Spaces with DESE and the MSBA. Discussion of this Diagram by the MSBA or DESE is informational in nature only and does not constitute a review or approval by the MSBA or DESE of the Chapter 74 Spaces that are represented by the Diagram. Districts are solely responsible for reviewing and implementing all laws, regulations, and guidelines issued by regulatory agencies, concerning Chapter 74 Spaces.

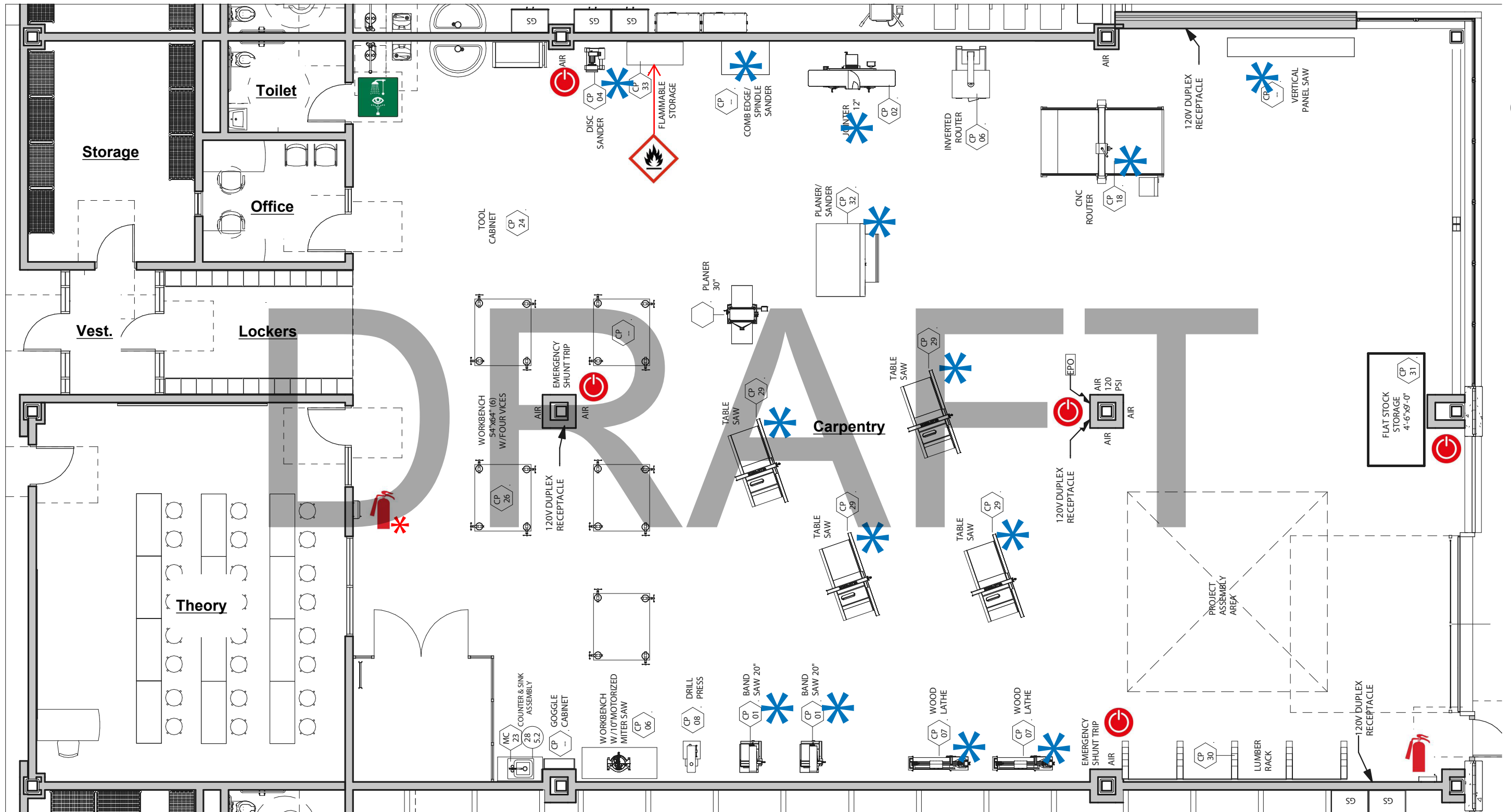

CP-05  
Dust Collector is located at the exterior of the building

Carpentry



Legend



Emergency Power Off (EPO)



Emergency Shower/Eyewash Combination Unit



Emergency Eyewash



Includes Fire Extinguisher



Flammable Cabinet

\* Equipment Vented to Dust Collector

Vocational School Name - Town/City, MA  
Massachusetts Department of Elementary & Secondary Education  
Chapter 74 Vocational Programs  
Date

This Diagram is being provided solely as an informational tool and it is not intended to represent an acceptable design for any specific facility. The legal requirements that govern the Design and Construction of a school facility are provided under Massachusetts General Law and these include any applicable requirements set forth in MGL c. 74. The MSBA is not responsible for the Owner's compliance with those legal requirements and compliance is the exclusive responsibility of the Owner and its professional consultants. This Diagram is for purposes of discussion of Chapter 74 Spaces with DESE and the MSBA. Discussion of this Diagram by the MSBA or DESE is informational in nature only and does not constitute a review or approval by the MSBA or DESE of the Chapter 74 Spaces that are represented by the Diagram. Districts are solely responsible for reviewing and implementing all laws, regulations, and guidelines issued by regulatory agencies, concerning Chapter 74 Spaces.

ITEM#	Q.T.Y.	DESCRIPTION
*> CP-01	2	BAND SAW, 20"
>		
*> CP-03	2	PLANER, 20"
>		
*> CP-05	1	SHOP VENTILATION SYSTEM
> CP-06	1	INVERTED ROUTER
*>		
CP-10	1	WORM DRIVE, 7-1/4"
CP-11	6	IMPACT DRILLS KIT
CP-12	6	CHUCK DRILL, 3/8"
CP-13	1	HAMMER DRILL
*>		
*> CP-18	1	ROUTER TABLE (CNC)
CP-21	2	FINISH NAILING GUNS
CP-22	2	BRAD NAILING GUNS
*> CP-23	1	SPINDLE SANDER
CP-27	3	WORKBENCH, 72"x30"
*> CP-29	1	PANEL TABLE SAW
*> CP-32	1	PLANER/SANDER
CP-33	1	FLAMMABLE STORAGE CABINET

DRAFT



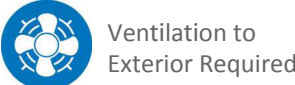



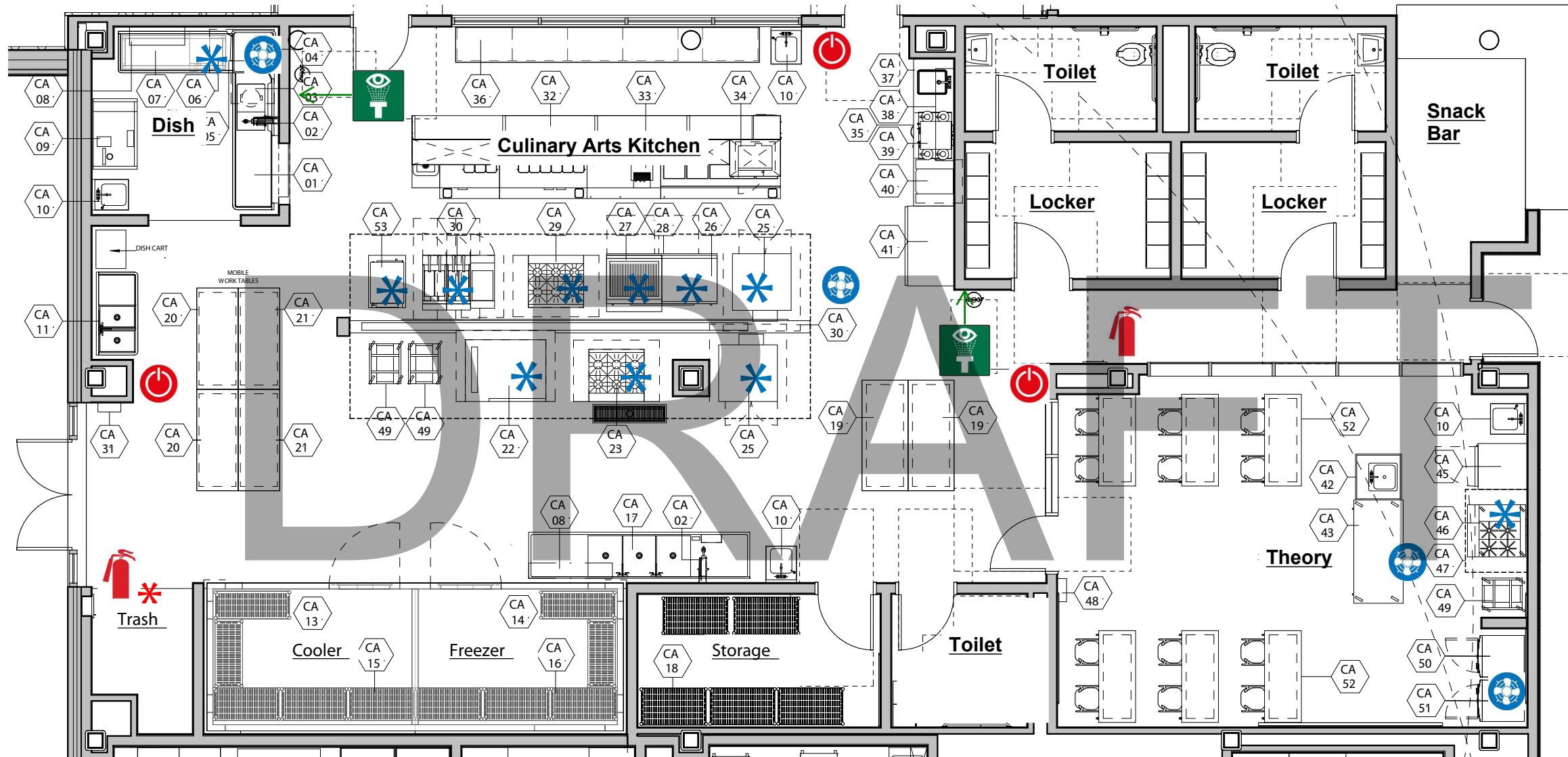

**Legend**



This Diagram is being provided solely as an informational tool and it is not intended to represent an acceptable design for any specific facility. The legal requirements that govern the Design and Construction of a school facility are provided under Massachusetts General Law and these include any applicable requirements set forth in MGL c. 74. The MSBA is not responsible for the Owner's compliance with those legal requirements and compliance is the exclusive responsibility of the Owner and its professional consultants. This Diagram is for purposes of discussion of Chapter 74 Spaces with DESE and the MSBA. Discussion of this Diagram by the MSBA or DESE is informational in nature only and does not constitute a review or approval by the MSBA or DESE of the Chapter 74 Spaces that are represented by the Diagram. Districts are solely responsible for reviewing and implementing all laws, regulations, and guidelines issued by regulatory agencies, concerning Chapter 74 Spaces.



Legend

-  Ventilation to Exterior Required
-  Emergency Power Off (EPO)
-  Emergency Shower/Eyewash Combination Unit
-  Emergency Eyewash
-  Fire Extinguisher
-  Flammable Cabinet
-  Includes Fire Blanket
-  Equipment Vented to Exhaust Hood

ITEM#	Q.T.Y.	DESCRIPTION
CA-03	1	DISPOSER
CA-05	1	EXHAUST HOOD
CA-06	1	HOT WATER BOOSTER
CA-07	1	CLEAN DISHTABLE
CA-08	1	WALL SHELF
CA-09	1	UTENSIL/PAN WASHER
CA-10	4	HAND SINK
CA-11	1	VEGETABLE PREP SINK
CA-12		
		☒
		CONDENSING UNIT EVAPORATOR COIL
		☒
		CONDENSING UNIT EVAPORATOR COIL
CA-19	2	WORKTABLE
CA-20	2	WORKTABLE
CA-21	2	WORKTABLE
CA-22	1	COMBINATION OVEN/STEAMER
CA-24		
		EQUIPMENT STAND, REFRIGERATED BASE
CA-29	1	FRYER ASSEMBLY
CA-30	1	EXHAUST HOOD
CA-32	1	CHEF'S TABLE ASSEMBLY
CA-33	1	TOASTER
CA-34	1	MICROWAVE
CA-35	1	ROLL WARMER
CA-36	1	S/S COUNTER ASSEMBLY
CA-37	1	S/S COUNTER W/SINK
CA-38	1	WALL SHELF
CA-39	1	COFFEE MAKER
CA-40	1	ICE CUBER
CA-42	1	COUNTER W/SINK
CA-43	1	DEMO TABLE W/REFRIGERATOR BASE
CA-45	1	REFRIGERATOR
CA-46	1	FOUR BURNER RANGE
CA-47	1	EXHAUST HOOD
CA-49	1	PAN RACK
CA-50	1	CLOTHES WASHER
CA-51	1	CLOTHES DRYER
CA-52	1	TWO-STUDENT WORKTABLE
CA-53	1	TWO COMPARTMENT STEAMER

This Diagram is being provided solely as an informational tool and it is not intended to represent an acceptable design for any specific facility. The legal requirements that govern the Design and Construction of a school facility are provided under Massachusetts General Law and these include any applicable requirements set forth in MGL c. 74. The MSBA is not responsible for the Owner's compliance with those legal requirements and compliance is the exclusive responsibility of the Owner and its professional consultants. This Diagram is for purposes of discussion of Chapter 74 Spaces with DESE and the MSBA. Discussion of this Diagram by the MSBA or DESE is informational in nature only and does not constitute a review or approval by the MSBA or DESE of the Chapter 74 Spaces that are represented by the Diagram. Districts are solely responsible for reviewing and implementing all laws, regulations, and guidelines issued by regulatory agencies, concerning Chapter 74 Spaces.

DRAFT

Legend



This Diagram is being provided solely as an informational tool and it is not intended to represent an acceptable design for any specific facility. The legal requirements that govern the Design and Construction of a school facility are provided under Massachusetts General Law and these include any applicable requirements set forth in MGL c. 74. The MSBA is not responsible for the Owner's compliance with those legal requirements and compliance is the exclusive responsibility of the Owner and its professional consultants. This Diagram is for purposes of discussion of Chapter 74 Spaces with DESE and the MSBA. Discussion of this Diagram by the MSBA or DESE is informational in nature only and does not constitute a review or approval by the MSBA or DESE of the Chapter 74 Spaces that are represented by the Diagram. Districts are solely responsible for reviewing and implementing all laws, regulations, and guidelines issued by regulatory agencies, concerning Chapter 74 Spaces.

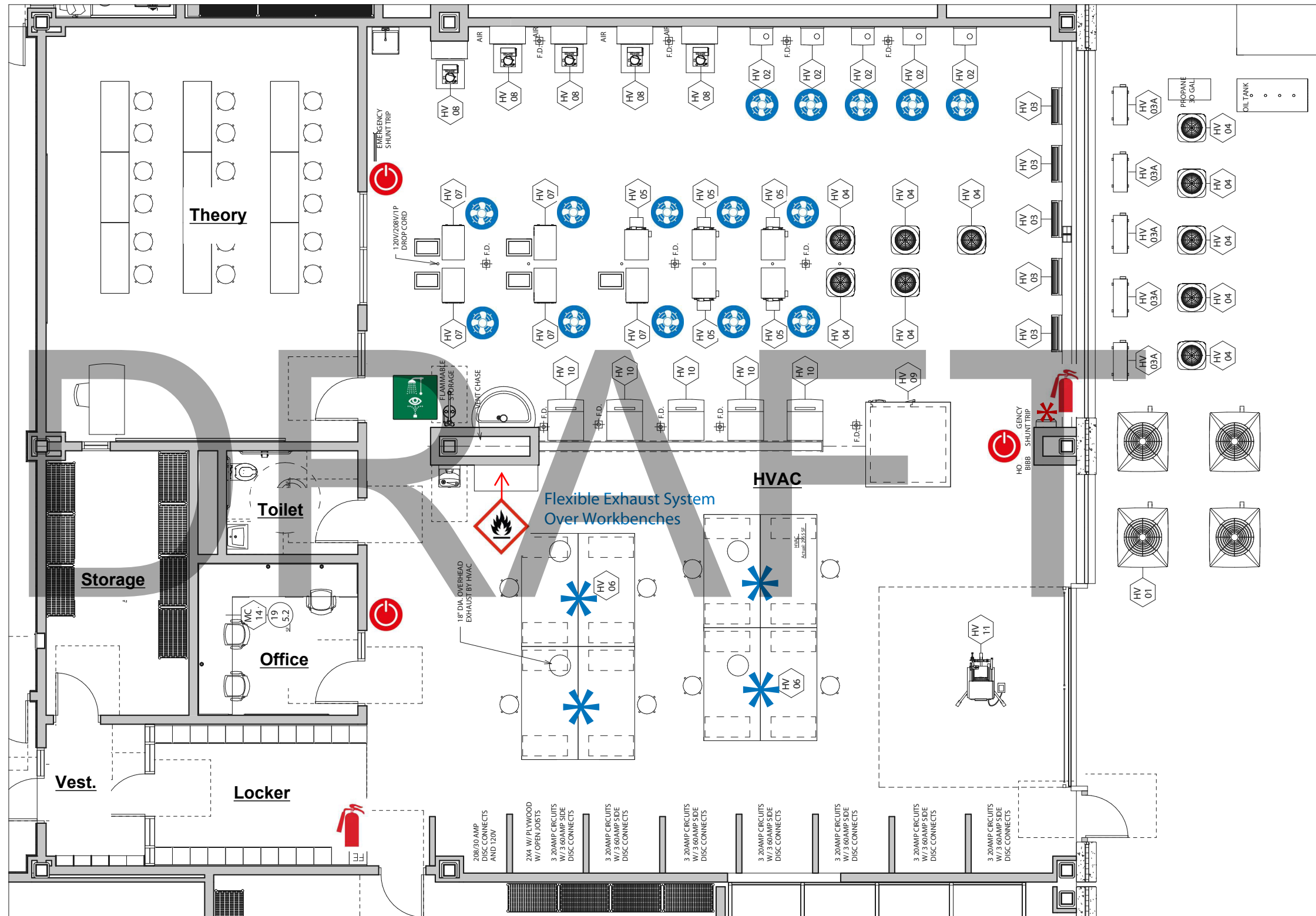

Legend

- Ventilation to Exterior Required
- Emergency Power Off (EPO)
- Flexible Exhaust System Over Workbench
- Emergency Shower/Eyewash Combination Unit
- Emergency Eyewash
- Fire Extinguisher
- Includes Fire Blanket
- Flammable Cabinet

This Diagram is being provided solely as an informational tool and it is not intended to represent an acceptable design for any specific facility. The legal requirements that govern the Design and Construction of a school facility are provided under Massachusetts General Law and these include any applicable requirements set forth in MGL c. 74. The MSBA is not responsible for the Owner’s compliance with those legal requirements and compliance is the exclusive responsibility of the Owner and its professional consultants. This Diagram is for purposes of discussion of Chapter 74 Spaces with DESE and the MSBA. Discussion of this Diagram by the MSBA or DESE is informational in nature only and does not constitute a review or approval by the MSBA or DESE of the Chapter 74 Spaces that are represented by the Diagram. Districts are solely responsible for reviewing and implementing all laws, regulations, and guidelines issued by regulatory agencies, concerning Chapter 74 Spaces.

ITEM#	Q.T.Y.	DESCRIPTION
HV-03	5	DUCTLESS SPLIT SYSTEM
HV-03 A		HVAC EXTERIOR
HV-04	10	1.5 TON CONDENSING UNIT
HV-05	5	OIL FIRED BOILER
HV-06	8	STEEL WORKBENCH TABLE
HV-07	5	GAS FIRED FURNACE
HV-08	5	MOCK REFRIG. SYSTEM
HV-09	1	WALK-IN FREEZER / COOLER
		CONDENSING UNIT
		EVAPORATOR COIL
		CONDENSING UNIT
		EVAPORATOR COIL
HV-10	5	ICE MACHINE
HV-11	1	PIPE THREADING MACHINE

DRAFT

**Legend**

 Ventilation to Exterior Required

 Flex Exhaust System Over Workbenches